

MacDon™

PW7
Pick-Up Header
Unloading & Assembly Instruction
Supplement for Container Shipments

This supplement includes instruction for removing double-unit shipping assemblies from the container, as well as instruction for separating the units. For all other Set-Up and Adjustment procedures, see the main Unloading & Assembly Instruction 169109 included with this shipment.

CONTAINER UNLOADING



CAUTION

To avoid injury to bystanders from being struck by machinery, do not allow persons to stand in unloading area.



CAUTION

Equipment used for unloading must meet or exceed the requirements specified below. Using inadequate equipment may result in chain breakage, vehicle tipping or machine damage.

LIFTING VEHICLE	
Min. Lifting Capacity *	8000 lb. (3636 kg)

* At 48 inches (1220 mm) from back end of forks.

IMPORTANT

Forklifts are normally rated for a load located 24 inches (610 mm) ahead of back end of the forks. To obtain the forklift capacity at 48 inches (1220 mm), check with your forklift distributor.

CHAIN	
Type	Overhead Lifting Quality (1/2 inch)
Min. Working Load	5000 lb. (2270 kg)

- Move trailer into position and block trailer wheels.
- Lower trailer storage stands.
- Open container doors and remove all blocking.
- Check container floor for nails or other obstructions and remove if necessary.

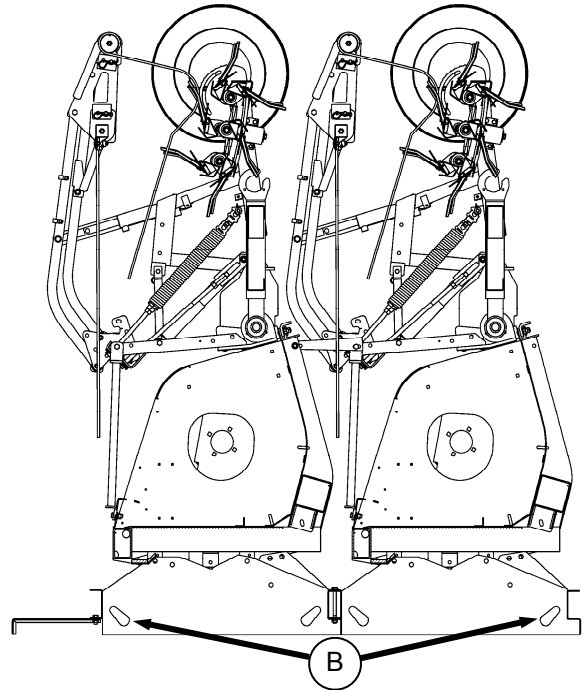
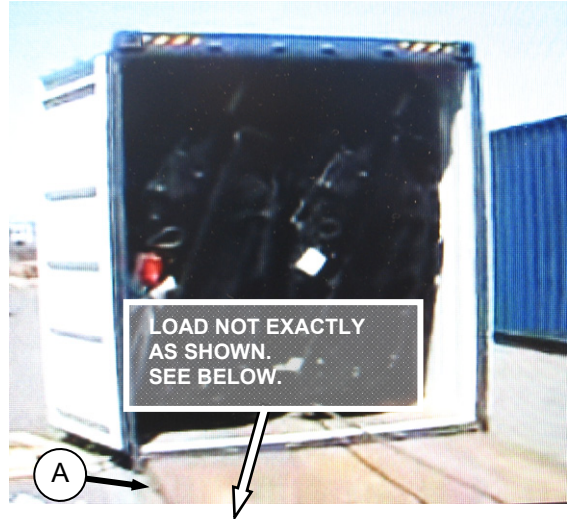

- Position platform (A) at container opening with forklift.
- Attach chains to points (B) on header shipping stands and to forks on a second forklift.
- Pull headers from container onto platform.
- Lift platform slightly to take weight off container.
- Raise trailer storage stands.
- Slowly drive trailer with container away from platform, carefully watching all clearances and repositioning headers as required.
- When container is clear of headers, lower platform and headers to ground.

SEPARATING UNITS

Remove shipping braces to separate the two-unit shipping assembly as follows:

NOTE: Depending on header sizes and types, hardware may not be in exact location shown.

- a. Remove left hand brace (A).

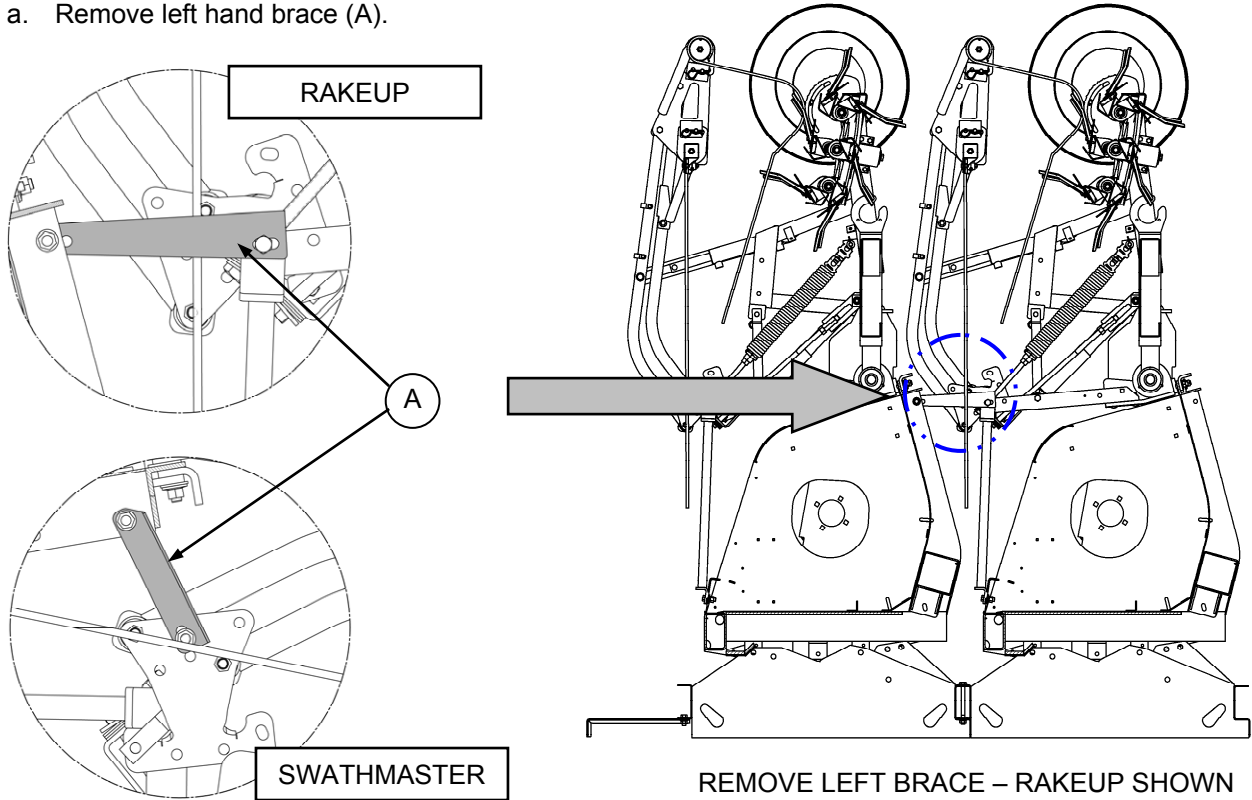

- b. Remove right hand brace (B).

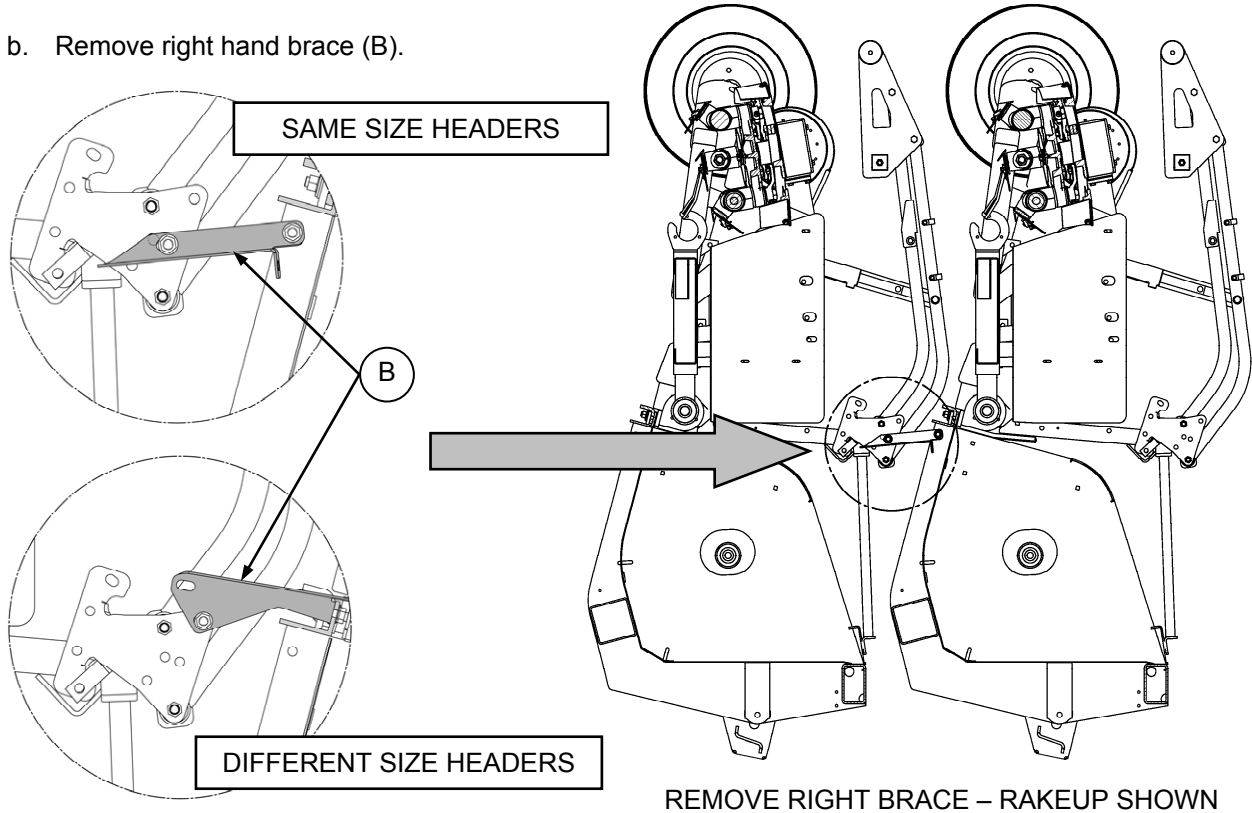

SEPARATING UNITS

- c. Remove two bolts (C) connecting the shipping stand lower members.

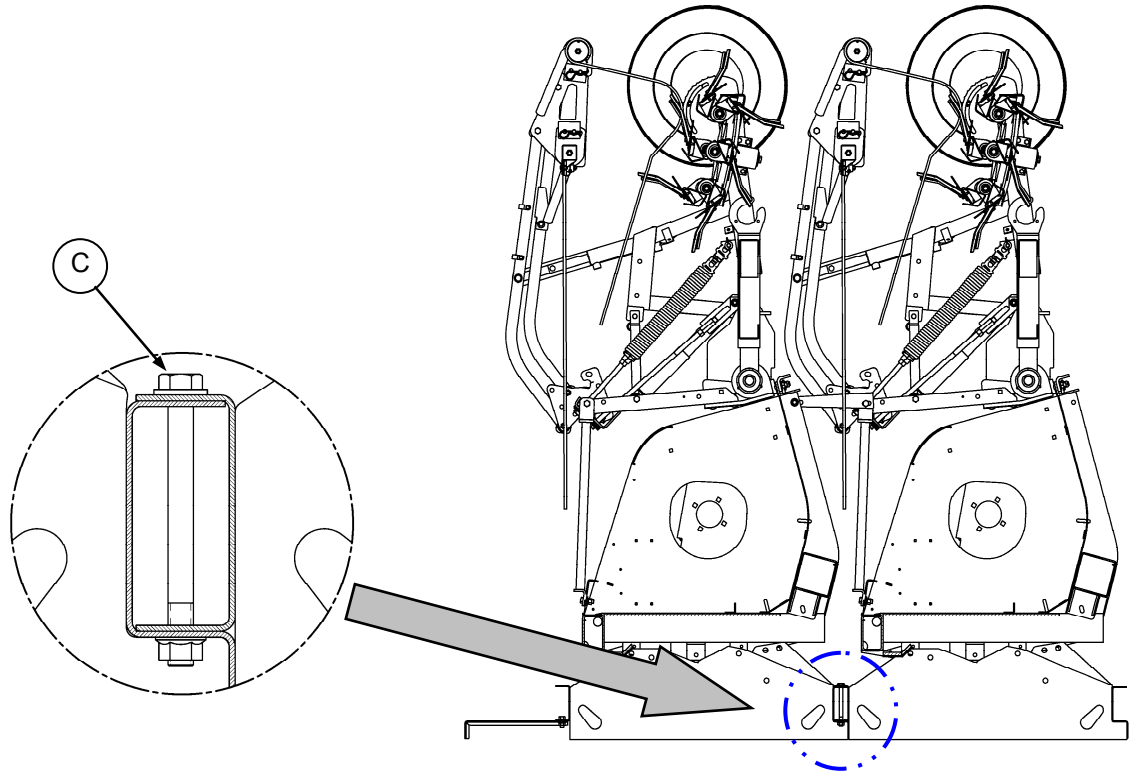

REMOVE TWO BOLTS – RAKEUP SHOWN

- d. Remove two container side-wall guides (D).
- e. Continue with positioning, lowering to field position and assembly using instruction 169109, included with this shipment.

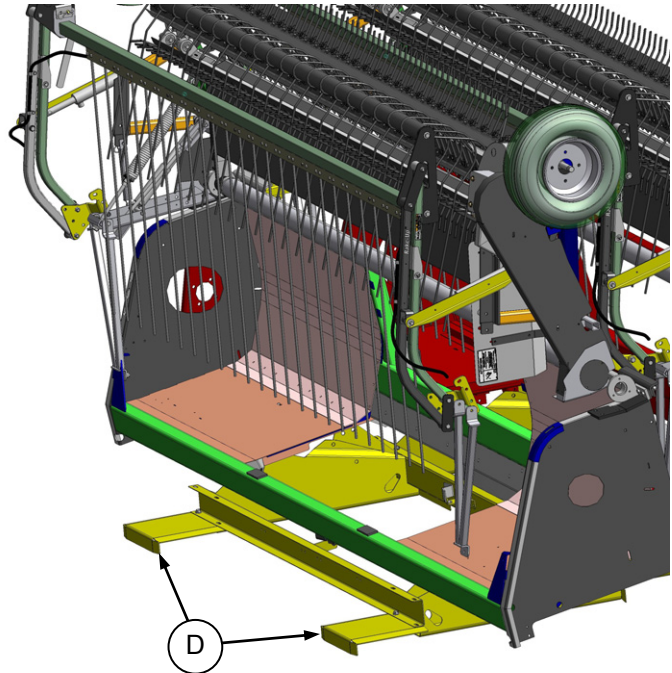

REMOVE TWO GUIDES

MacDon™

MacDon Industries Ltd.

680 Moray Street
Winnipeg, Manitoba
Canada R3J 3S3
t. (204) 885-5590
f. (204) 832-7749

MacDon Inc.

10708 N. Pomona Avenue
Kansas City, Missouri
United States, 64153-1924
t. (816) 891-7313
f. (816) 891-7323

MacDon Australia Pty. Ltd.

A.C.N. 079 393 721
P.O. Box 243
Suite 3, 143 Main Street
Greensborough, Victoria
Australia 3088
t. 03 9432 9982
f. 03 9432 9972

CUSTOMERS

www.macdon.com

DEALERS

www.macdondealers.com

Trademarks of products are the marks of their
respective manufacturers and/or distributors.

Printed in Canada