

**Model 801 Offset Mount Adapter  
For New Holland 9030 & TV140  
Bi-Directional Tractors**

**PARTS CATALOG**

**TABLE OF CONTENTS**

Frame & Float Group.....	2,3
Wheel Assembly.....	4,5
Hydraulics.....	6-9
Electrical.....	10,11
Header Completion Group .....	12,13
Decals.....	14,15
<b><u>NUMERICAL LIST</u></b> .....	<b>16</b>

**ABBREVIATIONS**

L/H - left hand (Determined from Operator's position, facing forward.)

R/H - right hand

I.D. - inside diameter

O.D. - outside diameter

A/R - as required (quantity varies)

REF - reference, part number called up elsewhere in catalog

SUB - Substitute (Revised design may be used to repair previous design when stock is depleted.)

NC - national coarse thread

NF - national fine thread

**NOTE:** Common hardware is not illustrated. Alphabetic references are used to designate position and description of these items.

When ordering, be sure the complete and proper serial number is given.

**SERIAL NUMBER BREAKS**

The side of the serial number on which the dash (-) appears determines whether the part is used "up to" or "after" the serial number given.

Example:	-74924	Used on machines up to and including serial number 74924.
	74925-	Used on machines including and after serial number 74925.



## FRAME &amp; FLOAT GROUP

REF	PART NUMBER	DESCRIPTION	QTY.	SERIAL NUMBER	
1	108121	FRAME – adapter, with decals.....	1		
2	40691	ARM – float, with bushings & lube fitting.....	2		
3	1134	BUSHING – bronze.....	4		
4	18671	FITTING – lube.....	2		
5	40611	SPACER – tube.....	2		
6	40545	SUPPORT – lower leg.....	2		
7	42498	PAD – rubber.....	2		
8	44575	PLATE – cover.....	2		
9	11695	WASHER – flat.....	2		
10	36837	PIVOT – float spring.....	4		
11	42690	SPRING – float, <b>standard</b> .....	4		
	<b>45858</b>	<b>SPRING – float, upgraded, see note 1</b> .....	<b>4</b>		
12	42691	INSERT – spring, lower.....	4		
13	24322	INSERT – spring, upper.....	4		
14	41122	DRAWBOLT – spring.....	4		
15	21540	WASHER – hardened.....	4		
16	40613	LINK – center, 960 Header.....	1		
17	20312	PIN – clevis, ¾ x 3 ¼ inch effective length (qty. 2 for 960 Hdr).....	1		
18	40554	CHAIN – linkage.....	2		
19	49341	PIN – upper link.....	1		
20	40615	SUPPORT – lower link, two-bolt.....	1		
21	40617	PIN – lower link.....	2		
22	50106	BALL – lower link, 9030 Tractor only.....	2		
23	108099	SUPPORT – lower link, three-bolt.....	1		
24	40720	WASHER – formed, 9030 Tractor only.....	4		
25	40758	ANCHOR – upper link, with decals.....	1		
26	25298	PROTECTOR – hose/wiring.....	3		
27	37635	CLEVIS – center link adjustment, 960 Header.....	1		
28	22072	WASHER – flat.....	4		
<b>30</b>	<b>108505</b>	<b>SUPPORT – tractor upper link, TV140 Tractor only (was 108098)</b> .....	<b>1</b>	<b>see note 2</b>	
31	REF	SUPPORT – hose, see “Hydraulics”.....	1		
32	108161	JOINT ASSEMBLY – center link, 962 & 972 Headers.....	1		
<b>33</b>	<b>158635</b>	<b>PIN – clevis, 1 x 3.35 inch eff. length, 962 &amp; 972 Headers</b> .....	<b>1</b>		
<b>34</b>	<b>135006</b>	<b>PIN – clevis, 28mm x 140mm effective length</b> .....	<b>1</b>		
<b>35</b>	<b>108524</b>	<b>KIT – upper link upgrade incl. items 30, 34, H, M, U &amp; instr</b> .....	<b>1</b>		
A	50107	BOLT – hex head, ¾ NC x 8 ½ inch	M	18640	WASHER – lock, ¾ inch
B	18689	NUT – lock, ¾ NC distorted thread	N	30597	BOLT – hex head, ¾ NC x 8 inch
C	30266	BOLT – round head, sq nk, ½ NC x 3 inch	P	21264	BOLT – hex head, 3/8 NC x 1 ¼ inch
D	21389	NUT – lock, ½ NC nylon insert	Q	18590	NUT – hex, 3/8 NC
E	18593	NUT – hex, ¾ NC	R	30228	NUT – lock, smth flange, 3/8 NC dist. Thd.
F	18610	PIN – cotter, ¼ x 2 ½ inch	S	18523	BOLT – rnd hd, sq nk, 5/8 NC x 1 ½ inch
G	18601	WASHER – flat, 13/16 inch ID	T	21378	NUT – hex jam, ¾ NC
H	102264	PIN – lynch, 3/16 x 1 9/16 inch	<b>U</b>	<b>135010</b>	<b>BOLT – hex head, 3/4 NC x 1-3/4 inch</b>
J	21587	BOLT – hex head, 5/8 NC x 2 inch	V	50193	PIN – lynch, 3/16 x 1 ¼ inch
K	18666	NUT – lock, 5/8 NC distorted thread	W	18723	BOLT – hex head, ½ NC x 1 ½ inch
L	16235	WASHER – flt, 1.7 OD x 0.81 ID x ¼ in thk	X	50186	NUT – lock, smth flange, ½ NC dist. thread

**NOTE:** 1). If float upgrade is required order kit 108522, which includes 2 of spring 45858 and installation instructions. If float upgrade is required on both sides of adapter, two kits will be required.

2). If replacing support 108098 order kit item 35.

# WHEEL ASSEMBLY

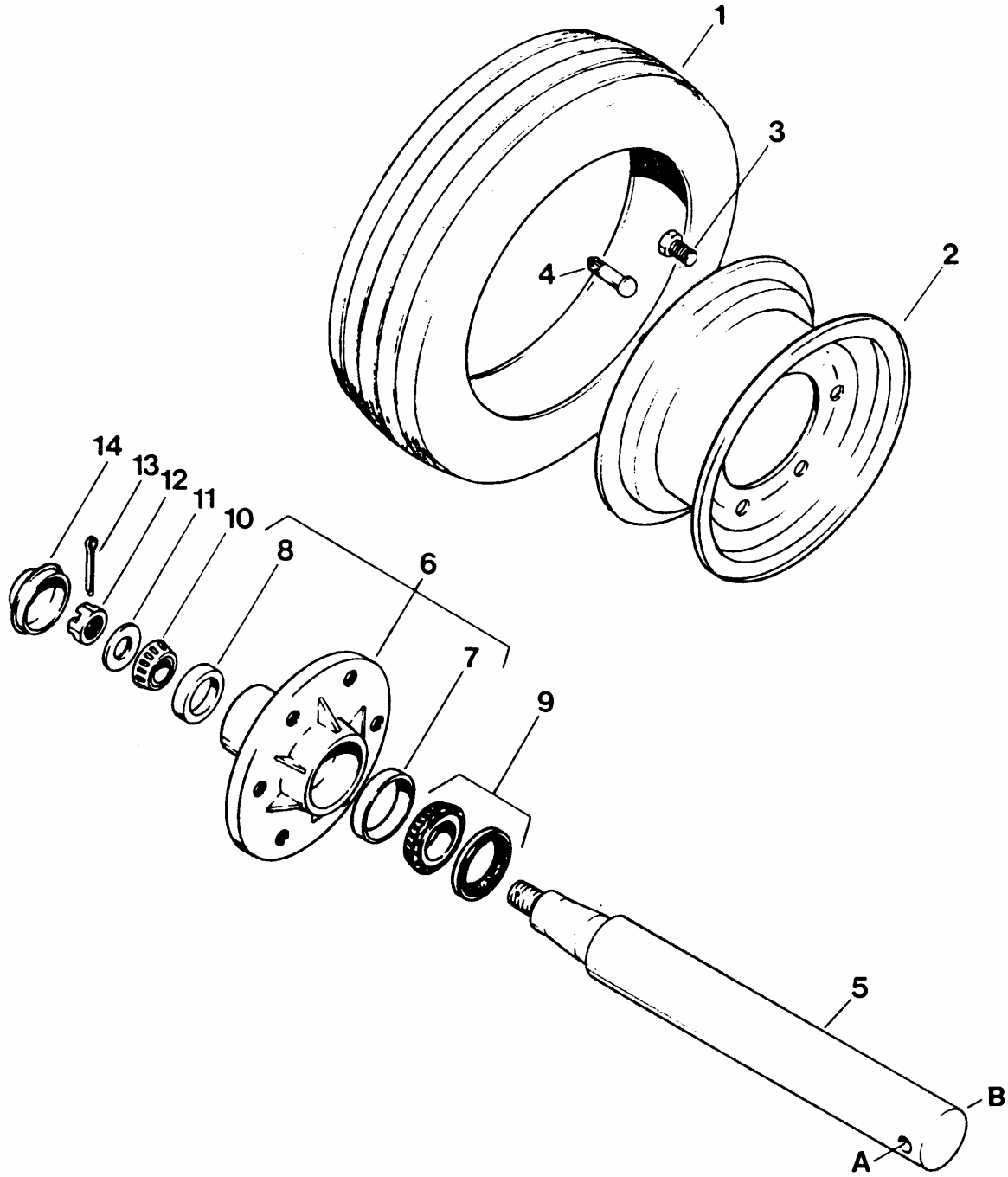

## WHEEL ASSEMBLY

REF	PART NUMBER	DESCRIPTION	QTY.	SERIAL NUMBER
1	30446	TIRE – 9.5L-14 Rib Implement.....	1	
2	30758	WHEEL – 6 bolt.....	1	
3	21719	BOLT – wheel .....	6	
4	21395	STEM – valve .....	1	
5	41155	SPINDLE – wheel .....	1	
6	30521	HUB – with cups, items 7 and 8.....	1	
7	30516	BEARING – cup, inner .....	1	
8	7900	BEARING – cup, outer .....	1	
9	30517	BEARING – cone, with seal .....	1	
10	21376	BEARING – cone.....	1	
11	21540	WASHER – flat, hardened.....	1	
12	5512	NUT – hex slotted, ¾ NF.....	1	
13	18648	PIN – cotter.....	1	
14	30520	CAP – dust .....	1	
A	21560	BOLT – hex head, ½ NC x 3 inch		
B	50186	NUT – lock, smooth flange, ½ NC distorted thread		

HYDRAULICS

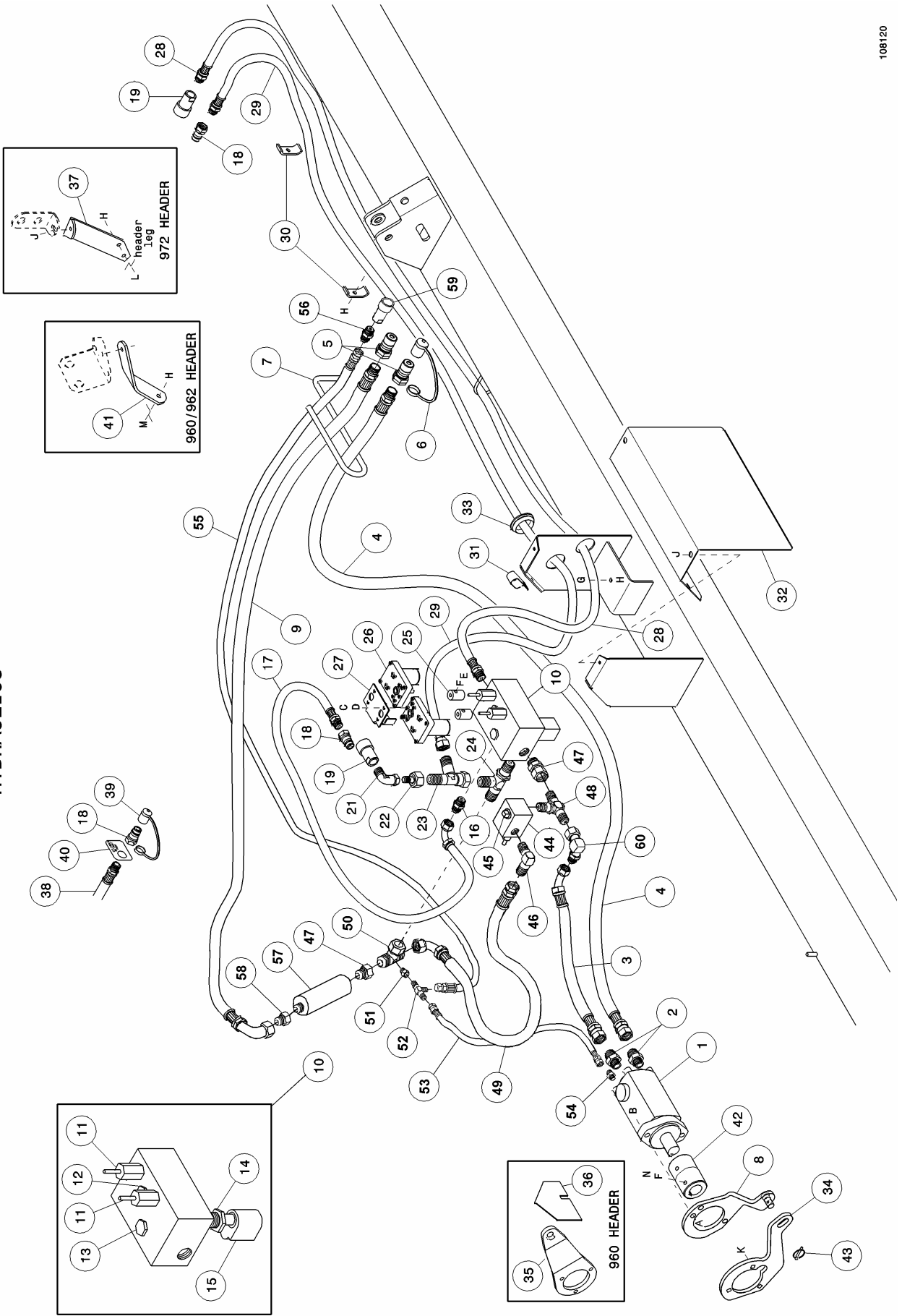

## HYDRAULICS

REF	PART NUMBER	DESCRIPTION	QTY.	SERIAL NUMBER
1	108063	MOTOR – hydraulic .....	1	
	40569	SEAL KIT – for motor 108063 .....		
2	30610	FITTING – adapter, 7/8 O-ring x ¾ tube .....	2	
	44210	O-RING – for 7/8 fitting .....		
3	108093	HOSE – motor “A” port to valve “P” port .....	1	
4	<b>108515</b>	<b>HOSE – motor “B” port to tractor PRESSURE coupler (was 108090)...</b>	<b>1</b>	
5	30871	COUPLER – male, 1 1/16 ORB .....	2	
6	50105	CAP – dust, for coupler 30871 .....	2	
7	108160	SUPPORT – hose .....	1	
8	108133	ARM – torque, motor mounted .....	1	
9	<b>108516</b>	<b>HOSE – tractor RETURN coupler to valve “T” port (was 108092) .....</b>	<b>1</b>	
10	<b>108519</b>	<b>VALVE – combination, includes items 11-15 (was 108067) .....</b>	<b>1</b>	
	45101	SEAL KIT – repairs <i>one</i> valve cartridge .....		
11	45109	FLOW CONTROL.....	2	
	45123	SETSCREW – for flow control 45109 .....		
12	45110	VALVE – shuttle .....	1	
13	45111	VALVE – regulator .....	1	
14	45107	VALVE – N.C.....	1	
15	45104	COIL – DS, 12VDC .....	1	
16	30695	FITTING – adapter, 7/8 O-ring x 5/8 tube .....	1	
	44210	O-RING – for 7/8 fitting .....		
17	40512	HOSE – valve “C” port to header draper pressure hose.....	1	
18	21855	COUPLER – male, ½ NPT .....	3	
19	<b>21857</b>	<b>COUPLER – female, ½ NPT .....</b>	<b>3</b>	
	50082	O-RING – for coupler 21857 .....		
20	21830	FITTING – adapter, 1 1/16 O-ring x ¾ tube .....	1	
	30971	O-RING – for 1 1/16 fitting .....		
21	50018	FITTING – elbow, 90°, 5/8 tube female x ½ NPT male.....	1	
22	30973	FITTING – reducer, 5/8 tube male x ¾ tube female.....	1	
23	50086	FITTING – swivel run tee, ¾ tube male (2) x ¾ tube female .....	1	
24	30858	FITTING – straight thread run, ¾ tube male (2) x 1 1/16 O-ring.....	1	
	30971	O-RING – for 1 1/16 fitting .....		
25	40567	HUB – connector, electric motor to valve .....	2	
26	42369	MOTOR – electric .....	2	
27	40682	STOP – motor.....	1	
28	43617	HOSE – valve “R” port to header reel pressure hose .....	1	
29	108141	HOSE – header reel return to tee at valve .....	1	
30	32225	HOLDER – hose .....	2	
31	103738	HOLDER – hose .....	1	
32	108110	COVER – valve assembly .....	1	
33	45298	GROMMET .....	2	
34	108134	ARM – torque, header mounted, 962 & 972 Headers.....	1	
35	108136	ARM – torque, header mounted, 960 Header .....	1	
36	108155	SHIELD – motor drive, 960 Header.....	1	
37	108175	SUPPORT – reel coupler mount, 972 2-Reel Arm Headers .....	1	
38	36848	HOSE – reel lift extension, 960 & 962 Headers .....	1	
	40333	HOSE – reel lift extension, 972 Header .....	1	
39	21856	CAP – dust, for coupler 21855 .....	1	
40	49417	TAG – hose routing instruction.....	1	
41	40695	SUPPORT – reel drive coupler mount, 960 & 962 Headers .....	1	
42	108065	COUPLING – motor, 1 3/8 inch shaft, 962 & 972 Headers.....	1	
	108066	COUPLING – motor, 1 3/16 inch shaft, 960 Header .....	1	
43	50193	PIN – lynch .....	1	

# HYDRAULICS

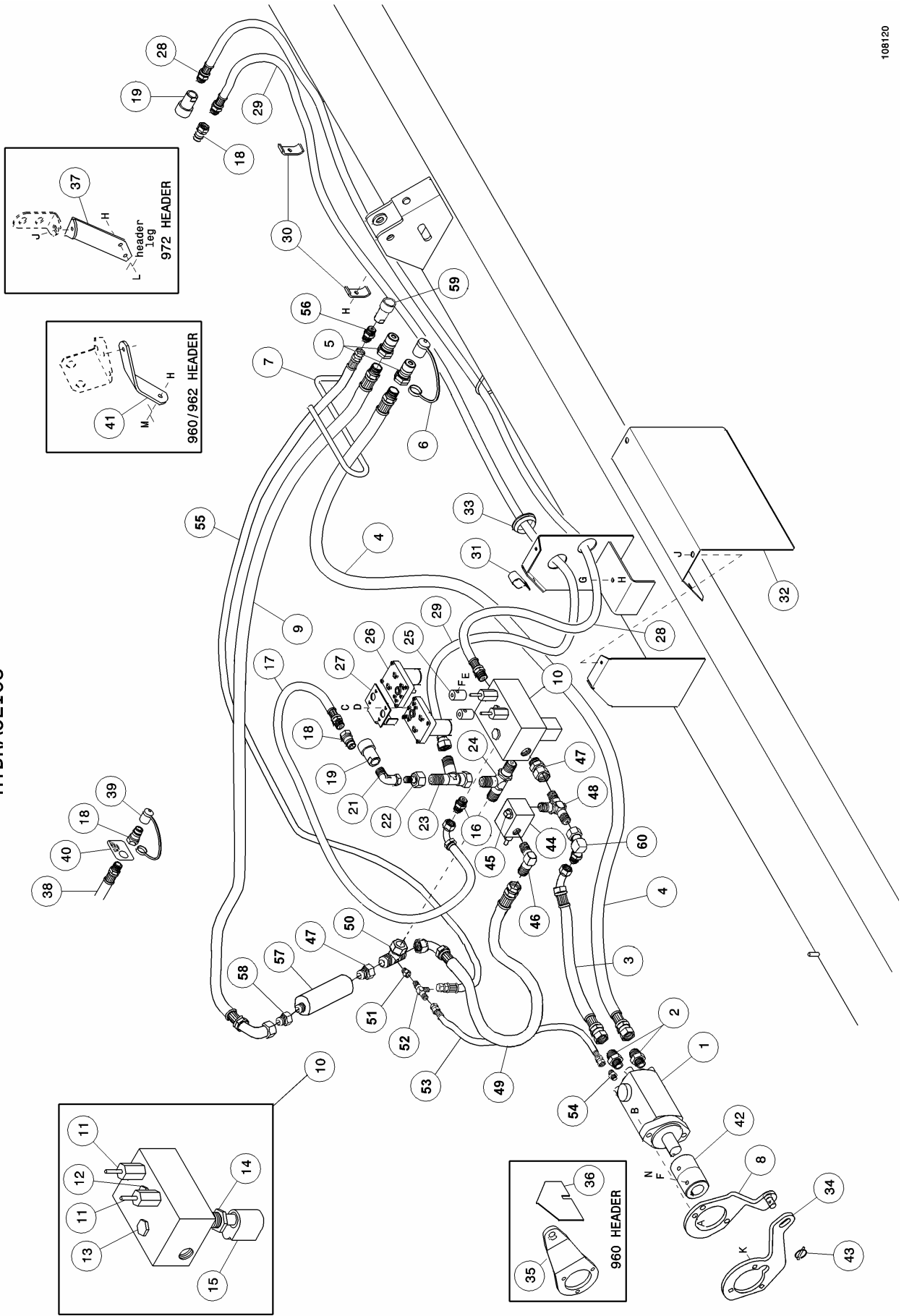

## HYDRAULICS

REF	PART NUMBER	DESCRIPTION	QTY.	SERIAL NUMBER
44	24508	VALVE - hydraulic .....	1	
45	30262	FITTING – hydraulic, sq hd, 1/2 in. npt, magnetic .....	1	
46	50077	FITTING – hydraulic, 90° elbow, sae 12-8 .....	1	
47	40241	FITTING – hydraulic, connector, sae 12-12 male/female (was 21830).	2	
48	21832	FITTING – hydraulic, tee, sae 12-12-8.....	1	
49	44195	HOSE – hydraulic .....	1	
50	108513	FITTING – hydraulic tee, special, with ¼ npt tap in side .....	1	
51	108502	FITTING – hydraulic, restrictor, 0.0935 orifice.....	1	
52	135005	FITTING – hydraulic, tee, ¼ pipe x 6 JIC x 6 JIC .....	1	
53	31802	HOSE – hydraulic .....	1	
54	100790	FITTING – hydraulic, adapter, sae 6-4 .....	1	
55	31805	HOSE – hydraulic .....	1	
56	114141	FITTING – hydraulic, adapter, sae 6-10 .....	1	
57	108501	VALVE – hydraulic, check .....	1	
58	21830	FITTING – hydraulic, connector, sae 12-12.....	1	
59	108226	COUPLING – hydraulic, .500 in. #10 orb .....	1	
60	108521	FITTING – elbow, 90° elbow, sae 12-12 male/female, 1/4npt tap in side.....	1	
61	21858	PLUG – hydraulic, dust.....	1	
A	21565	BOLT – hex head, ½ NC x 1 ¾ inch		
B	18697	NUT – lock, ½ NC distorted thread		
C	30955	SCREW – machine, #8 x 5/16 inch		
D	21185	WASHER – lock, #10 internal tooth		
E	21248	SCREW – set, 3/8 NC x ¾ inch		
F	18664	NUT – hex jam, 3/8 NC		
G	21593	BOLT – hex head, 3/8 NC x 4 inch		
H	30228	NUT – lock, smooth flange, 3/8 NC distorted thread		
J	101898	SCREW – flange head, self-tapping, 3/8 x 5/8 inch		
K	19966	BOLT – round head, square neck, 3/8 NC x 1 ¼ inch		
L	19965	BOLT – round head, square neck, 3/8 NC x 1 inch		
M	21863	BOLT – round head, short square neck, 3/8 NC x ¾ inch		
N	18908	SCREW – set, 3/8 NC x 1 inch		

# ELECTRICAL

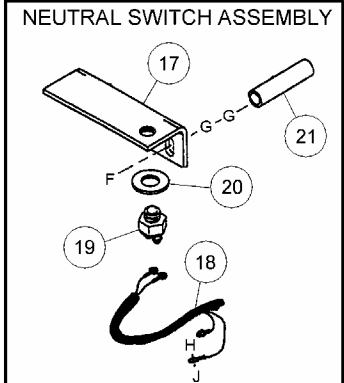
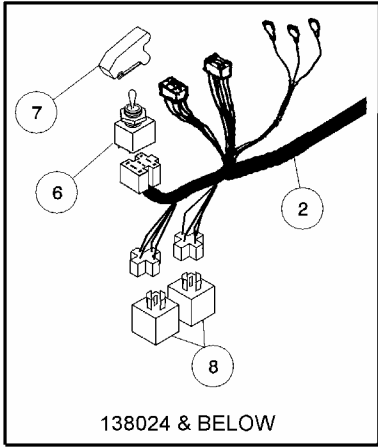
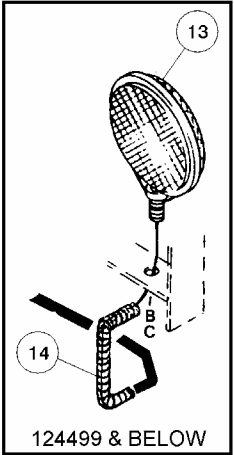
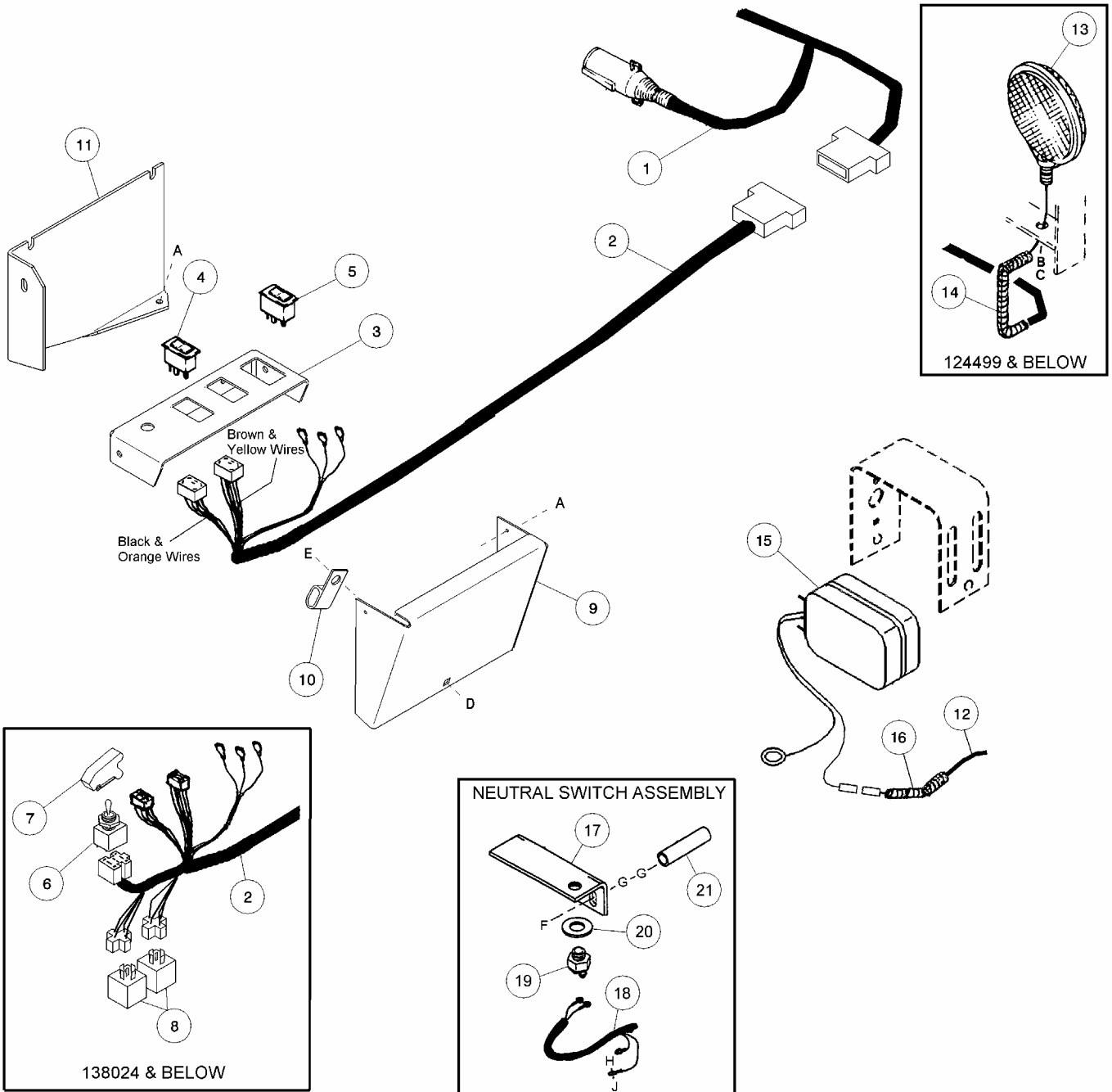

## ELECTRICAL

REF	PART NUMBER	DESCRIPTION	QTY.	SERIAL NUMBER
1	108077	HARNESS – wiring, adapter section .....	1	
	30710	PLUG – 7-pole, included with harness 108077 .....		
2	108080	HARNESS – wiring, switch panel section .....	1	-124499
	108267	HARNESS – wiring, switch panel section .....	1	124500-131619
	<b>108523</b>	<b>HARNESS – wiring, switch panel section .....</b>	<b>1</b>	<b>131620-</b>
3	108082	PANEL – switch, with decal.....	1	-131619
	<b>108284</b>	<b>PANEL – switch, with decal.....</b>	<b>1</b>	<b>131620-</b>
4	42256	SWITCH – reel and draper speed .....	2	
5	113543	SWITCH – deck shift – Hydraulic Shift Headers only (was 42257) ..	1	-131619
	<b>109063</b>	<b>SWITCH – deck shift – Hydraulic Shift Headers only .....</b>	<b>1</b>	<b>131620-</b>
6	108074	SWITCH – toggle, header engage .....	1	-124499
	108224	SWITCH – toggle, header engage .....	1	124500-131619
7	108223	GUARD – header engage switch .....	1	-124499
	42841	GUARD – header engage switch .....	1	124500-131619
8	30215	RELAY .....	2	-131619
9	108191	COVER – switch panel .....	1	
10	39272	HOLDER – harness .....	1	
11	108192	MOUNT – switch panel, TV140 tractor only .....	1	
12	108159	HARNESS – wiring, adapter lights .....	1	
13	16539	LIGHT – amber .....	2	-124499
14	33860	CONDUIT – harness protector at R/H light .....	1	-124499
15	<b>113511</b>	<b>LIGHT – amber, rectangular – includes M5 hardware .....</b>	<b>2</b>	<b>124500-</b>
		<b>BULB – replacement # 1156</b>		
16	<b>45156</b>	<b>CONDUIT – harness protector .....</b>	<b>2</b>	<b>124500-</b>
17	<b>49415</b>	<b>SUPPORT – switch .....</b>	<b>1</b>	
18	<b>49414</b>	<b>HARNESS – wiring, neutral switch .....</b>	<b>1</b>	
19	<b>30009</b>	<b>SWITCH – neutral .....</b>	<b>1</b>	
20	<b>18600</b>	<b>WASHER – flat, 21/32 ID X 1-5/16 inch .....</b>	<b>1</b>	
21	<b>45434</b>	<b>SPACER – tube .....</b>	<b>2</b>	
A	42292	SCREW – self-tapping, Type A, hex washer head, #10 x 1/2 inch		
B	18638	WASHER – lock, 1/2 inch		
C	6771	NUT – hex, 1/2 NF		
D	21926	BOLT – round head, square neck, 1/4 NC x 1/2 inch		
E	21455	NUT – serrated flange lock, 1/4 NC		
F	<b>21579</b>	<b>BOLT – hex head, 3/8 NC x 3-1/4 inch</b>		
G	<b>18598</b>	<b>WASHER – flat, 13/32 inch ID.</b>		
H	<b>30955</b>	<b>SCREW – self drilling, self tapping, #12 x 1 inch</b>		
J	<b>18796</b>	<b>NUT – hex, #8 NC</b>		

# HEADER COMPLETION GROUP

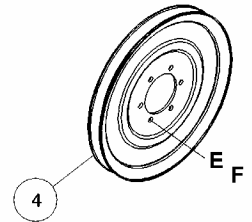
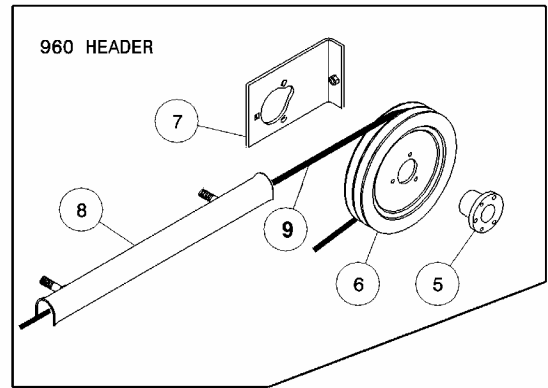
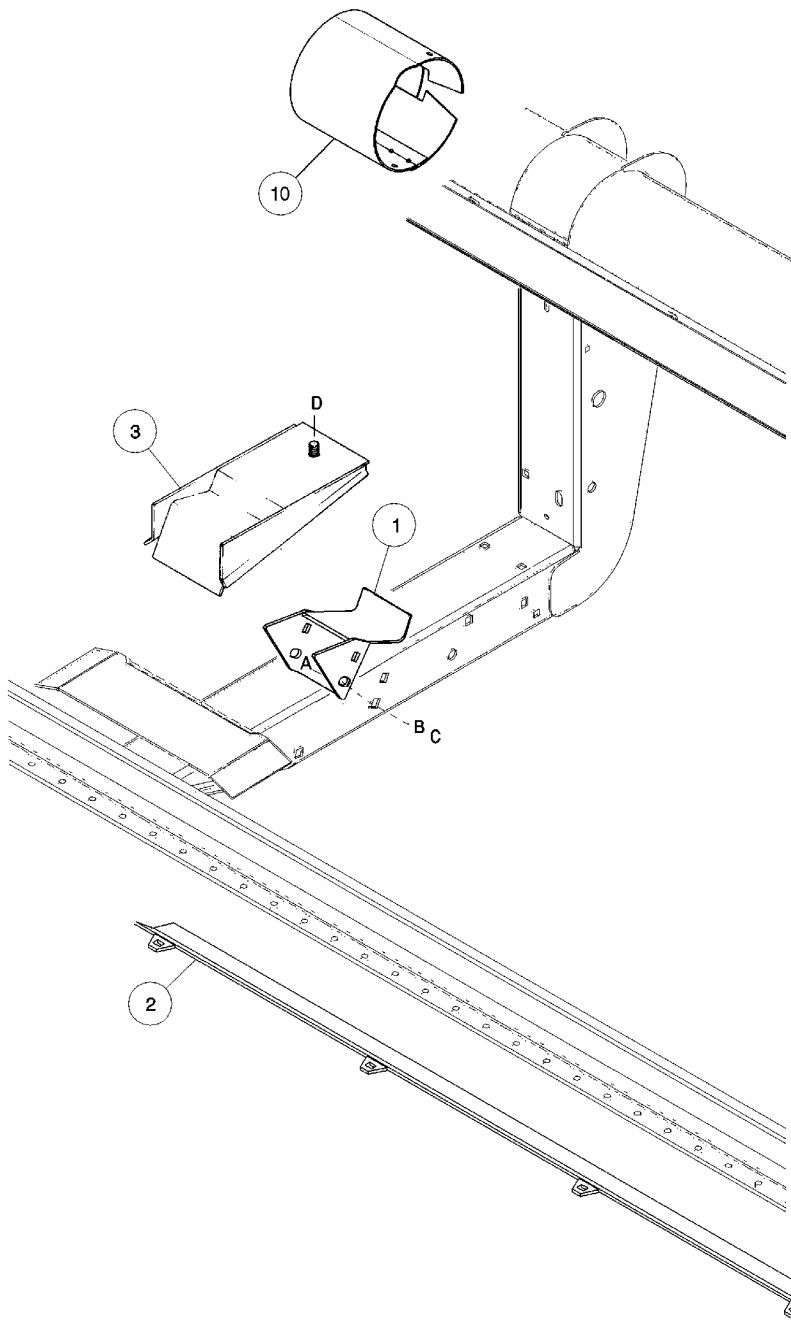

## HEADER COMPLETION GROUP

REF	PART NUMBER	DESCRIPTION	QTY.	SERIAL NUMBER
1	117036	ADAPTER – pocket for adapter leg, 972 Headers (was 102428).....	2	
2	102412	PLATE – wear, center section, 972 Headers .....	1	
3	43301	ADAPTER – pocket for adapter leg, 960 & 962 Headers .....	2	
4	100050	PULLEY – 13” O.D., sickle drive for 962 & 972 Headers.....	1	
5	37104	BUSHING – split taper, sickle drive pulley, 960 Headers .....	1	
6	108108	PULLEY – sickle drive, (use inner groove), 960 Headers.....	1	
7	108150	BRACKET – belt tightener, 960 Headers .....	1	
8	108157	GUIDE – belt, upper strand, 960 Headers .....	1	
9	38151	BELT – sickle drive, 960 Headers .....	1	
<b>10</b>	<b>108518</b>	<b>SHIELD – driveline, 972 header.....</b>	<b>1</b>	<b>138025-</b>
<b>A</b>	<b>117028</b>	<b>BOLT – round head, square neck, 5/8 NC x 6-1/2 inch</b>		
B	18639	WASHER – lock, 5/8 inch		
C	18592	NUT – hex, 5/8 NC		
D	18666	NUT – lock, 5/8 NC distorted thread		
E	18637	WASHER – lock, 3/8 inch		
F	20077	BOLT – hex head, 3/8 NC x 1 inch		

DECALS

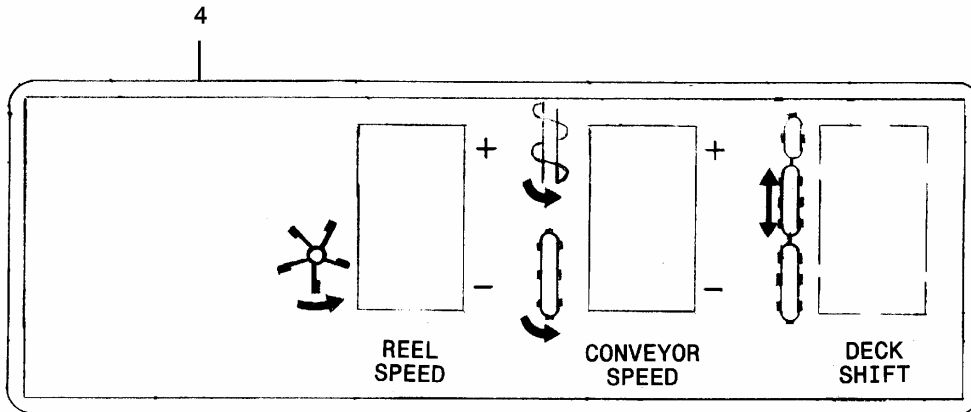
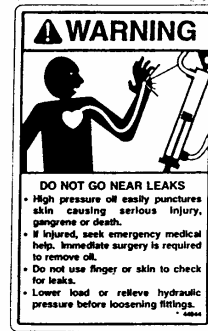
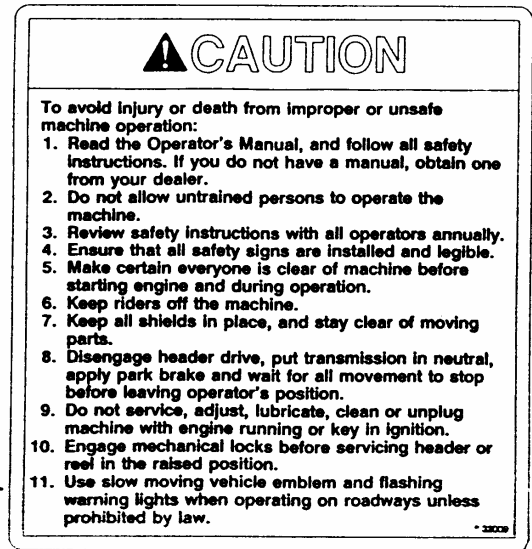
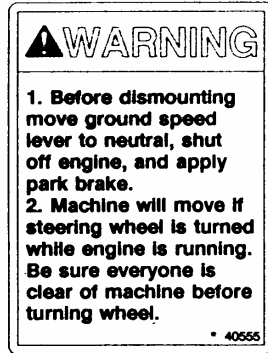
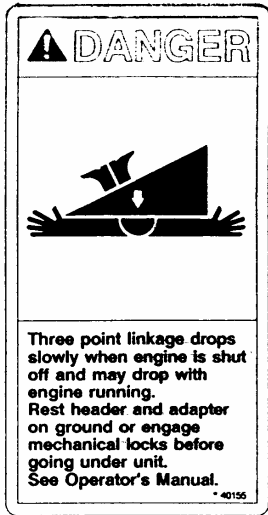

DECALS

REF	PART NUMBER	DESCRIPTION	QTY.	SERIAL NUMBER
1	40155	DECAL – Danger: Three Point Linkage .....	2	
2	40555	DECAL – Warning: Controls to Neutral .....	1	
3	32009	DECAL – Caution: General Safety .....	1	
4	108083	DECAL – Switch Panel .....	1	-131619
	<b>108283</b>	<b>DECAL – Switch Panel (shown) .....</b>	<b>1</b>	<b>131620-</b>
5	23165	DECAL – 50 Hour Grease .....	2	
6	26697	REFLECTOR – amber .....	2	
7	26694	REFLECTOR – red .....	2	
8	44944	DECAL – Warning: Hydraulic Oil Leaks .....	1	

## NUMERICAL LIST

<u>PART NO.</u>	<u>PAGE</u>	<u>PART NO.</u>	<u>PAGE</u>	<u>PART NO.</u>	<u>PAGE</u>
1134 .....	3	36848 .....	7	49414 .....	11
5512 .....	5	37104 .....	13	49415 .....	11
7900 .....	5	37635 .....	3	49417 .....	7
11695 .....	3	38151 .....	13	50018 .....	7
16539 .....	11	39272 .....	11	50077 .....	9
18600 .....	11	40155 .....	15	50082 .....	7
18648 .....	5	40241 .....	9	50086 .....	7
18671 .....	3	40333 .....	7	50105 .....	7
20312 .....	3	40512 .....	7	50106 .....	3
21376 .....	5	40545 .....	3	50193 .....	7
21395 .....	5	40554 .....	3	100050 .....	13
21540 .....	3	40555 .....	15	100790 .....	9
21540 .....	5	40567 .....	7	102412 .....	13
21719 .....	5	40569 .....	7	103738 .....	7
21830 .....	7	40611 .....	3	108063 .....	7
21832 .....	9	40613 .....	3	108065 .....	7
21855 .....	7	40615 .....	3	108066 .....	7
21856 .....	7	40617 .....	3	108074 .....	11
21857 .....	7	40682 .....	7	108077 .....	11
21858 .....	9	40691 .....	3	108080 .....	11
22072 .....	3	40695 .....	7	108082 .....	11
23165 .....	15	40720 .....	3	108083 .....	15
24322 .....	3	40758 .....	3	108093 .....	7
24508 .....	9	41122 .....	3	108099 .....	3
25298 .....	3	41155 .....	5	108108 .....	13
26694 .....	15	42256 .....	11	108110 .....	7
26697 .....	15	42257 .....	11	108121 .....	3
30009 .....	11	42369 .....	7	108133 .....	7
30215 .....	11	42498 .....	3	108134 .....	7
30262 .....	9	42690 .....	3	108136 .....	7
30446 .....	5	42691 .....	3	108141 .....	7
30516 .....	5	43301 .....	13	108150 .....	13
30517 .....	5	43617 .....	7	108155 .....	7
30520 .....	5	44195 .....	9	108157 .....	13
30521 .....	5	44210 .....	7	108159 .....	11
30610 .....	7	44210 .....	7	108160 .....	7
30695 .....	7	44575 .....	3	108161 .....	3
30710 .....	11	44944 .....	15	108175 .....	7
30758 .....	5	45101 .....	7	108191 .....	11
30858 .....	7	45104 .....	7	108192 .....	11
30871 .....	7	45107 .....	7	108223 .....	11
30971 .....	7	45109 .....	7	108224 .....	11
30971 .....	7	45110 .....	7	108226 .....	9
30973 .....	7	45111 .....	7	108267 .....	11
31802 .....	9	45123 .....	7	108283 .....	15
31805 .....	9	45156 .....	11	108284 .....	11
32009 .....	15	45298 .....	7	108285 .....	11
32225 .....	7	45434 .....	11	108501 .....	9
33860 .....	11	45858 .....	3	108502 .....	9
36837 .....	3	49341 .....	3	108505 .....	3
				108513 .....	9
				108515 .....	7
				108516 .....	7
				108518 .....	13
				108519 .....	7
				108521 .....	9
				108522 .....	3
				108523 .....	11
				108524 .....	3
				109063 .....	11
				113511 .....	11
				113543 .....	11
				114141 .....	9
				117036 .....	13
				135005 .....	9
				135006 .....	3
				158635 .....	3